



**NORDIC**  
PT. BAHARI LINES INDONESIA

## M.V. NORDIC BARAKUDA



**CREW / UTILITY / SURVEY VESSEL**

### PT. BAHARI LINES INDONESIA

Menara Satu Sentra Kelapa Gading  
Jl. Boulevard Raya LA3 No. 1, Lt 08 # 0801  
Kelapa Gading, Jakarta 14240, INDONESIA  
Tel: +6221 29375731 / +6221 29375732

### NORDIC MARITIME PTE LTD

3 Harbour front Place  
# 04-03 Harbour Front Tower 2  
Singapore 099254  
Tel: +65 62350354 / Fax: +65 62353271



# M.V. NORDIC BARAKUDA

CREW/ UTILITY/ SURVEY VESSEL

## PARTICULAR

NAME OF VESSEL : M.V. NORDIC BARAKUDA  
TYPE OF VESSEL : Crew/ Utility/ Survey Vessel  
CALL SIGN : YB4956  
YEAR BUILT : 2015  
CLASS : ABS  
TYPE : +A1 HSC Crew Boat  
IMO No. : 525005379

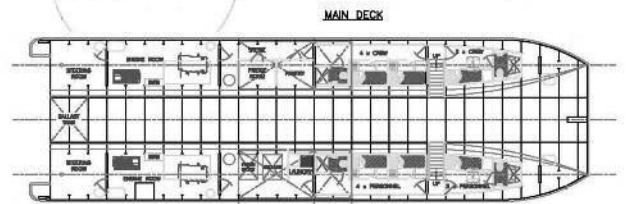
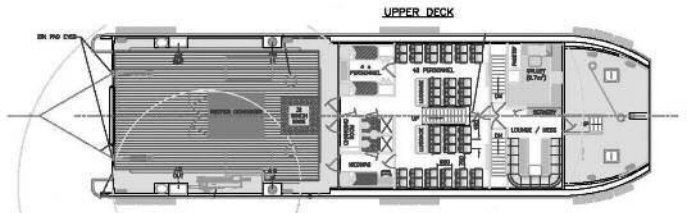
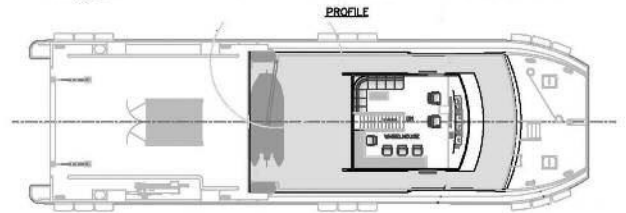
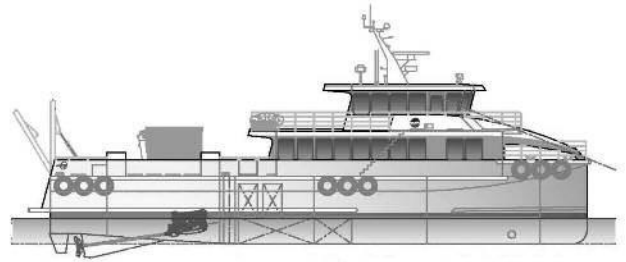

## PRINCIPAL PARTICULAR

Length overall (inc. jets) : 29.90 m  
Length Waterline : 28.50 m  
Beam : 8.5 m  
Depth : 3.6 m  
Draft Loaded : 2.3 m  
Diesel Fuel : 30.0 m<sup>3</sup>  
Fresh Water : 1.5 m<sup>3</sup>  
Black Water : 1.5 m<sup>3</sup>  
Deck Load : 3T/m<sup>2</sup>  
Deck Area : 70.0 m<sup>2</sup>

## MACHINERY/ PROPULSION

Main Engines : 2 x CAT C18 533kW/ 715 hp @ 2100 rpm  
Generator : 2 x CAT C4.4 86 kva/ 69 ekw  
Gearbox : ZF2150  
Propulsion : 2 x Fixed pitch 5 blade propellers  
Bow Thrusters : 2 x 550 kgf  
Bilge/ Ballast/ Deck Pump : 2 x 8 m<sup>3</sup>/hr  
Fuel oil transfer pump : 10 m<sup>3</sup>/hr @ 1 bar  
OWS : 1 unit

Endurance : 30days @ 5 Knots  
Speed : 18 Knots @ 100% load

## ACCOMMODATION & SAFETY

Passengers : 60 paxs (42 Seats and 18 Beds)  
Lifebuoys : 4 Units  
Distress rockets : 1 Set (12 Flares)  
Hand flares : 12 Set Red Hand Flares  
Life Jacket : 30 Unit Life Jacket  
Life rafts : 6 Units (25 Person Each) (03 Port side & 03 STBD side)  
EPIRB : 1 Unit

## COMMUNICATION EQUIPMENT

One (1) sets VHF / FM, 2 way radio  
One (1) Loud hailer  
One (1) V-Sat Kuband c/w FBB  
AIS - 1 Unit  
GPS - 1 Unit  
Radar - 1 Unit

## DECK EQUIPMENT

Deck crane : 2T@ 5M & 500 kgs @ 10m  
A Frame : 3T SWL  
Workboat : Rigid inflatable boat c/w70Bhp

\*A particulars presented are believed to be accurate but given entirely without warranty. Interested parties are advised to verify details through inspections.